

DC MOTOR

60W
~200W

□90mm

DIMENSIONS

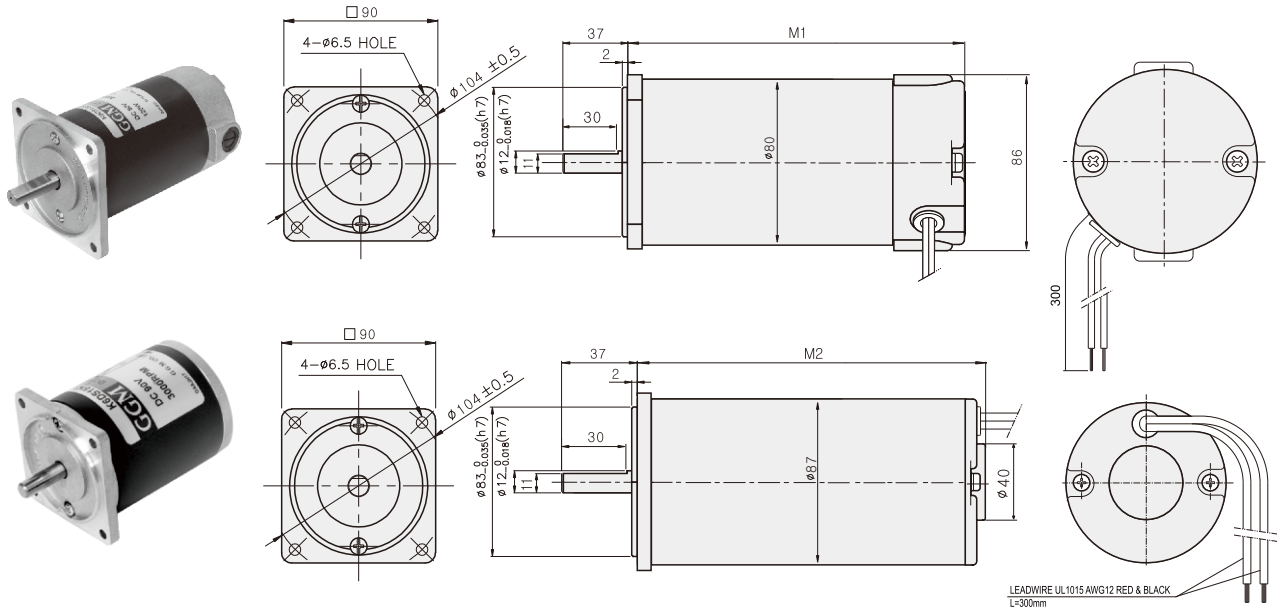

CONNECTION DIAGRAMS

RED → ⊕ CW
BLACK → ⊖ CCW

※ The direction of motor rotation is as viewed from the front shaft end of the motor

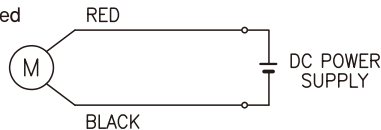

DIMENSION TABLE

M1	∅	MOTOR	M2	∅	MOTOR
143	80	K9D□60N□ K9D□90N□	170	87	K9D□150N1 K9D□200N1 K9D□200N2
168		K9D□120N□ K9D□150N2 K9D□150N3 K9D□200N3			

SPECIFICATIONS

Model	Output (W)	Voltage (V)	RATED			Start T. (N·m/kgf·cm)	Starting Current (A)
			Speed (rpm)	Torque (N·m/kgf·cm)	Current (A)		
K9D□60N1	60	12	3000	0.19/1.9	12	1.46/14.6	80
K9D□60N2		24			4.6	2.73/27.3	60
K9D□60N3		90			1.4	2.18/21.8	13
K9D□90N1	90	12	3000	0.3/3	13.4	1.63/16.3	76
K9D□90N2		24			5.9	3/30	67
K9D□90N3		90			1.6	2.3/23	14
K9D□120N1	120	12	3000	0.39/3.9	17.9	1.75/17.5	90
K9D□120N2		24			7.7	3.95/39.5	85
K9D□120N3		90			1.9	4.39/43.9	25
K9D□150N1	150	12	3000	0.49/4.9	21.1	2.22/22.2	111
K9D□150N2		24			9	4.29/42.9	94
K9D□150N3		90			2.5	5/50	30
K9D□200N1	200	12	3000	0.65/6.5	28	1.8/18	89
K9D□200N2		24			12	5.2/52	124
K9D□200N3		90			3.3	5.55/55.5	32

* □ : SHAFT SHAPE (S : STRAIGHT, P : PINION)